

TPS25

Header Box Orbital Weld Head

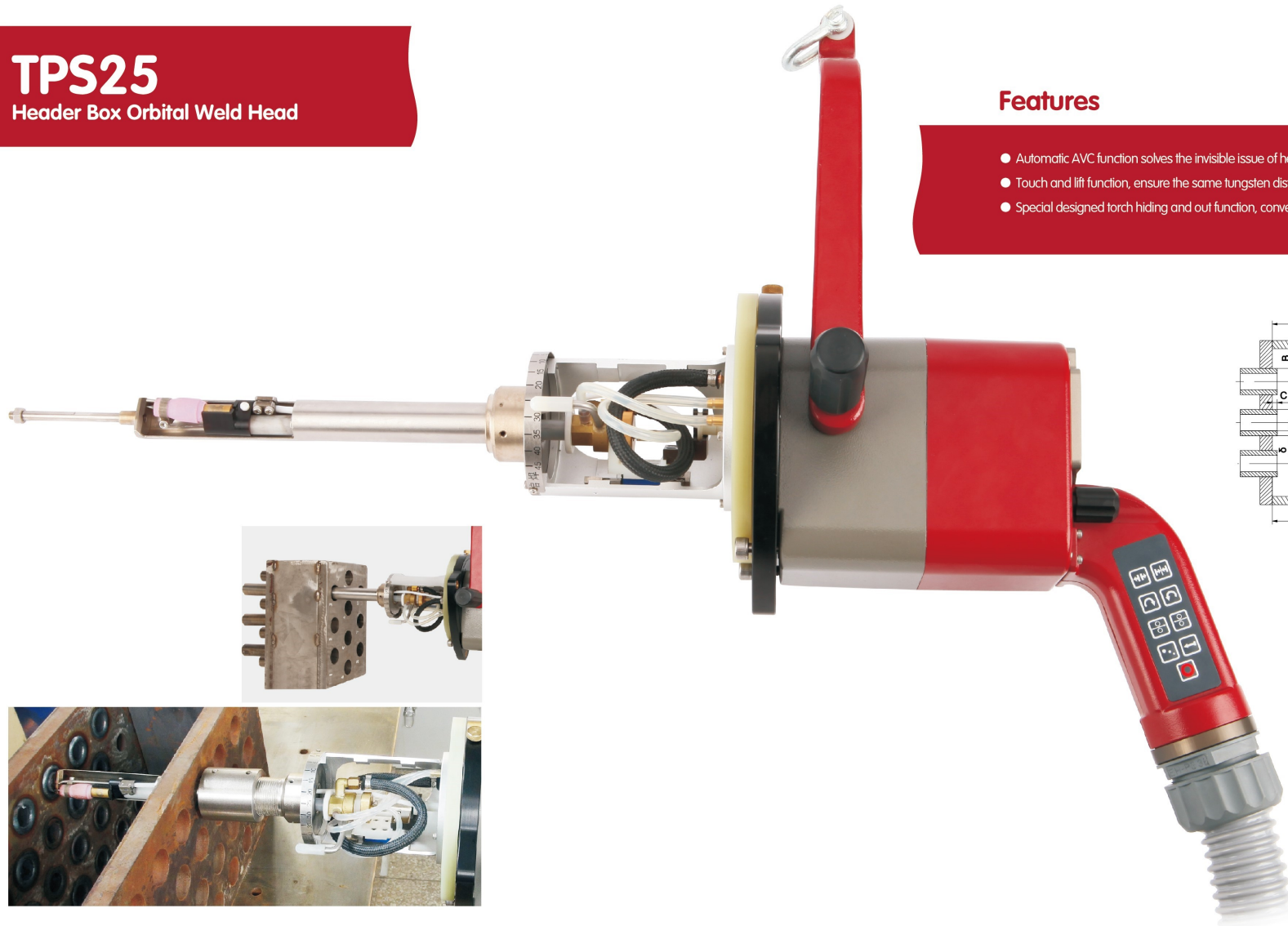

Features

- Automatic AVC function solves the invisible issue of header box welding, optional manual AVC;
- Touch and lift function, ensure the same tungsten distance to work piece;
- Special designed torch hiding and out function, convenient to insert the torch and carry out welding job.

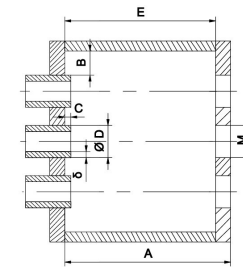

Main dimension (mm)

M	M32 x 2	M36 x 3
ΦD	Φ25	Φ32
A	80 ≤ A ≤ 230	
B	≥ 10	
C	≈ 1.5	
δ	≈ 3.5	

Technical specification

Material	Carbon steel, stainless steel
Tube OD (mm)	Φ25, Φ32 (standard Φ25)
Max Depth for Inner Tube (mm)	230 (including plate thickness)
Connection	Flush tube
Tungsten diameter (mm)	Φ2.4
Rotation speed (rpm)	0.37 ~ 7.39
Torch Angle	-3°
Arc adjusting distance (mm)	18
Max wire feeding speed (mm/min)	1800
Tungsten diameter (mm)	Φ0.8
Protective gas	Ar
Cooling	Water
Cooling flow (ml/min)	≥ 300
Duty cycle	200A 60%
Weight (kg)	13 (no cable)
Dimension (mm)	780 x 290 x 310

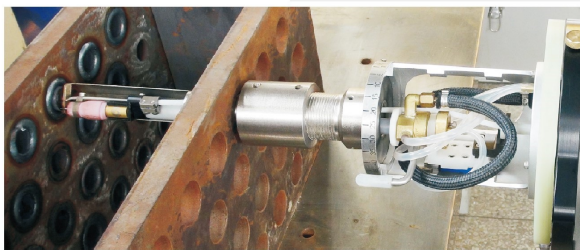
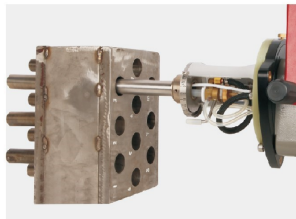

Summary

This weld head is special designed for header box tube/tube sheet orbital TIG welding. It can weld $\phi 25$ and $\phi 32$ mm carbon steel and stainless steel tube flush with or without wire feeding. It's compatible with Huaheng iOrbital5000 programmable digital welding power source to apply in boiler, heat exchanger, power plant, chemical industries etc. to achieve precision TIG header box welding with high quality and repeatability.

